

Expect Superior Performance

In thermal tests, **Vytex® Potomac-hp Series® EnerCore™** *outperforms* Aluminum and Steel

Potomac-hp **EnerCore™** Reinforcement performs

533 times

better than Aluminum

Competitor window with Aluminum



VS

Vytex Potomac-hp Series® EnerCore™



Potomac-hp **EnerCore™** Reinforcement performs

160 times

better than Steel

Competitor window with Steel



VS

Vytex Potomac-hp Series® EnerCore™

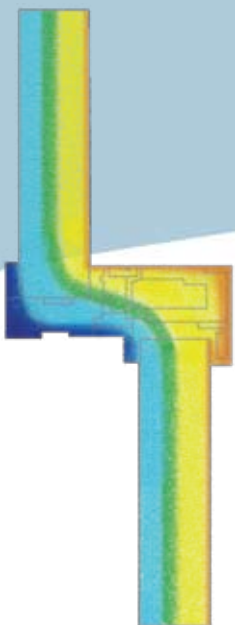

This thermal test shows cold temperature transfers are restricted by our thermally efficient composite reinforcement.

Energy Saver Plus-hp™

Vytex Corporation Double Hung Low-E HP FFS AC POLY - Energy Vinyl Frame * Double Glazed	
ENERGY PERFORMANCE RATINGS	
U-Factor (U.S./F)	Solar Heat Gain Coefficient
0.26	0.20
ADDITIONAL PERFORMANCE RATINGS	
Visible Transmittance	Air Leakage (U.S./F)
0.48	
<small>Manufacture declares that these ratings conform to applicable NFRC procedures for determining energy product performance. NFRC ratings are only valid for a list of all participating manufacturers and a specific product line. NFRC does not warrant any product data and does not accept the liability of any products for any specific use. Contact manufacturer's website for other product performance information.</small>	

Energy Saver Max-hp™

Vytex Corporation Double Hung Low-E HP FFS AC POLY - Energy Vinyl Frame * Triple Glazed	
ENERGY PERFORMANCE RATINGS	
U-Factor (U.S./F)	Solar Heat Gain Coefficient
0.18	0.18
ADDITIONAL PERFORMANCE RATINGS	
Visible Transmittance	Air Leakage (U.S./F)
0.34	
<small>Manufacture declares that these ratings conform to applicable NFRC procedures for determining energy product performance. NFRC ratings are only valid for a list of all participating manufacturers and a specific product line. NFRC does not warrant any product data and does not accept the liability of any products for any specific use. Contact manufacturer's website for other product performance information.</small>	

Energy Saver Ultimate-hp™

Vytex Corporation Double Hung Low-E HP FFS AC POLY - Energy Vinyl Frame * Triple Glazed Krypton * No G1	
ENERGY PERFORMANCE RATINGS	
U-Factor (U.S./F)	Solar Heat Gain Coefficient
0.15	0.18
ADDITIONAL PERFORMANCE RATINGS	
Visible Transmittance	Air Leakage (U.S./F)
0.34	
<small>Manufacture declares that these ratings conform to applicable NFRC procedures for determining energy product performance. NFRC ratings are only valid for a list of all participating manufacturers and a specific product line. NFRC does not warrant any product data and does not accept the liability of any products for any specific use. Contact manufacturer's website for other product performance information.</small>	

Vytex windows
Clearly, a Cut Above™